



**2.1** Megapixel    4.0mm Fixed Lens    DMP Integration    True WDR    IP66 Rated    **5 YEAR** Warranty

## Summary

The DMP® series of MEGApix® IP cameras are seamlessly integrated into a DMP alarm panel, providing visual verification and data for alarms triggered in the DMP system. The cameras are easily integrated into any DMP existing system via the cloud, delivering a simple installation process and the added power of crystal-clear 2.1MP/1080p resolution images.

## Features

- 2.1MP/1080p 1/2.7" image sensor
- 4.0mm fixed lens
- DMP integration
- True Wide Dynamic Range (WDR)
- Dual codecs (H.264, MJPEG) with simultaneous streaming
- 60' Smart IR™ with intelligent camera sync
- Smart DNR™ 3D digital noise reduction
- True day/night mechanical IR cut filter
- Auto gain control (AGC)
- Auto white balance (AWB)
- Motion detection
- PoE class 2 and DC12V
- ONVIF conformant, profile S
- IP66 environmental-rated dust-tight and water-resistant
- 5 year warranty

## Dimensions

unit : Inch (mm)

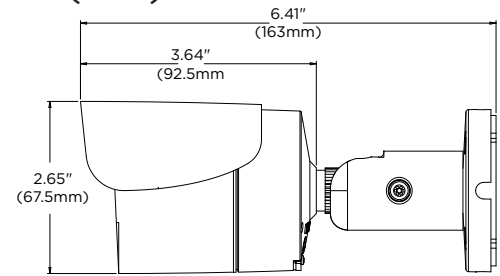

## Specifications



Designed and engineered in U.S.A and Korea

IMAGE	
Image sensor	2.1MP/1080p 1/2.7" CMOS
Total pixels	1928 (H) x 1088 (V)
Minimum scene illumination	0.41 lux (color) 0.0 lux (B/W)
LENS	
Focal length	4.0mm, F2.0
Lens type	Fixed lens
Field of view (FoV)	88°
IR distance	60ft range
OPERATIONAL	
Shutter mode	Auto, manual, anti-flicker, slow shutter
Shutter speed	1/30 - 1/8000
Slow shutter	1-1/5, 1/7.5, 1/15
Auto gain control	Auto
Day / night	Auto, day (color), night (B/W)
Smart DNR™ 3D digital noise reduction	0 - 11
Wide dynamic range (WDR)	True WDR on, off
Wide dynamic range (WDR) dB	120dB
Backlight Compensation (BLC)	On / off / HSBLC
Mirror & Flip	Yes
Alarm notifications	Notifications via e-mail, FTP server
NETWORK	
LAN	802.3 compliance 10/100 LAN
Video compression type	H.264
Resolution	H.264: 1080p/720p/VGA/D1/CIF
Frame rate	Up to 30fps
Video bitrate	100Kbps - 10Mbps, Multi-rate for preview and recording
Bitrate control	Multi-streaming CBR/VBR at H.264 (controllable frame rate and bandwidth)
Streaming capability	Dual-stream at different rates and resolutions
IP	IPv4
Protocol	ONVIF, TCP/IP, UDP, autoIP, RTP(UDP/TCP), RTSP, NTP, HTTP, HTTPS, SSL, DNS, DDNS, DHCP, FTP, SMTP, ICMP, SNMPv1/v2c/v3(MIB-2)
Security	HTTPS (SSL), IP filtering, 802.1x, digest authentication (ID/PW)
ONVIF conformance	Yes
Video management software	DW Spectrum® IPVMS
ENVIRONMENTAL	
Operating temperature	14°F - 122°F (-10°C - 50°C)
Operating humidity	Less than 90% (non-condensing)
IP rating	IP66 certified
Other certifications	CE, FCC, RoHS, UL listed
ELECTRICAL	
Power requirement	DC 12V, PoE (IEEE 802.3af Class 3). (adaptor not included)
Power consumption	DC12V: max 5.6W PoE: max 7.3W
MECHANICAL	
Material	Aluminum bullet housing
Dimensions	6.41" x 2.65" (163 x 67.5 mm)
Weight	1.1 lbs (0.5kg)

