

FUJIFILM
expect INNOVATION™

Precision Focus Lenses



XA88x8.8BE SM



Technology That Inspires...

FUJINON

For design help, accessories or pricing, please contact:
sales@avsupply or call: 1-858-565-1101

AUDIOVIDEO SUPPLY
1-800-284-2288 sales@avsupply.com
www.avsupply.com

Distributed By: Audio Video Supply -- Tel: 1-800-284-2288 -- www.avsupply.com

XA88x8.8BE SM



LENS	XA88x8.8BE SM
Zoom Ratio / Format	88X / 2/3"
Focal Length	8.8 ~ 777 mm
Extender	(2X) 17.6 ~ 1554 mm
Maximum Relative Aperture	1:1.7 (8.8 ~ 348 mm)
Maximum Photometric Aperture T-No.	1:3.8 (777 mm)
Angular Field of View (Hor. x Vert. in °)	8.8 mm 57° 10' x 34° 03'
16:9 Aspect Ratio	777 mm 0° 42' x 0° 24'
	(2X) 17.6 mm 30° 29' x 17° 25'
	1554 mm 0° 21' x 0° 12'
M.O.D. from Image Plane	3.56 m
M.O.D. from Front of Lens	2.9 m
Object Dimensions at M.O.D.	8.8 mm 3029 x 1703 mm
(Hor. x Vert. in mm)	777 mm 34 x 19 mm
16:9 Aspect Ratio	(2X) 17.6 mm 1515 x 851 mm
Size (HxWxL)	1554 mm 17 x 10 mm
Weight (w/o Hood)	26 kg

PF-BUILT-IN LENSES

Fujinon's Precision Focus Assist enables camera operators the ability to ensure fast accurate focusing of high definition images under varying conditions. The PF system is the first to incorporate Fujinon's patented system which utilizes a unique contrast method of achieving precise focus.



FEATURES AND FUNCTIONS

Contrast focusing method

The Precision Focus System adopts a contrast method that utilizes differences in optical path length. It can instantly focus the image without searching for focus and can maintain precise focus even when following moving objects.

CCD A and CCD B are built into the lens barrel to detect the focusing conditions and are positioned at equal distances before and after the camera image-forming plane.

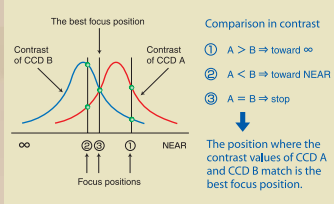

CAN BE MOUNTED ON ANY 2/3" CAMERA

The PF function is built into the lens and can be operational with the lens mounted on a 2/3" camera with no additional settings or optional devices. Camera software provides additional viewfinder information on some cameras.

FOCUS MODE SELECTION

The momentary mode provides for PF function only when pressing the button or the continuous mode may be selected for continuous PF function. These two modes of operation provide precise focusing according to the shooting situation, whether a still or moving image.

FOCUS AREA SETTING

When the PF lens is mounted on a camera, a focus area is shown on the viewfinder. The size and the position of the focus area can be changed at the camera operator's discretion. This function allows greater flexibility in the selection of the focus area depending on the type of production.

Camera viewfinder image

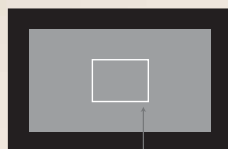

User selectable

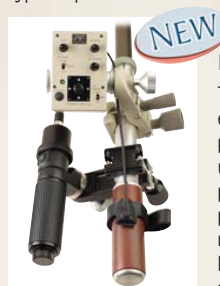

USER FRIENDLY PF CONTROLLER

The new focus controller for Fujinon's exclusive Precision Focus Assist provides operators with a simple to use yet powerful tool to maintain precise focus in the most demanding production situations. The familiar manual type focus controller has been adapted to encompass all of the precise servo features of the PF lens.

Fujinon's exclusive Precision Focus Assist is now in the fourth generation and features improved focusing response, lower light loss and reduced size. The PF system is the only focusing system that can maintain focus at any zoom position from the narrowest to the widest angle.

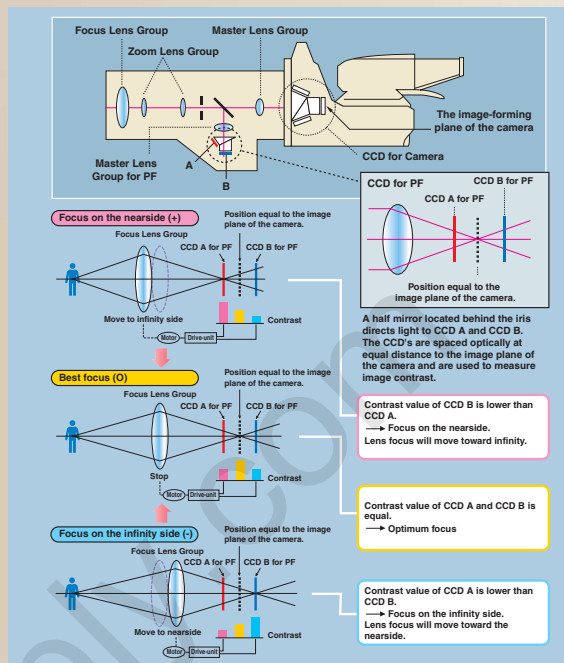

ACCESSORIES: HD PF CONTROLS ENG/EPF

SS-13PF Servo Focus/Servo Zoom

For use with PF ENG lenses.

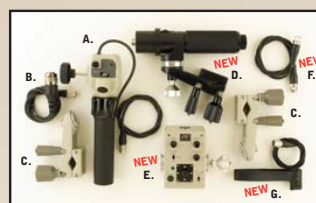
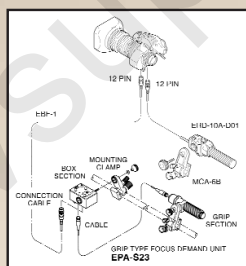

- A. ERD-10A-D01 Digi Zoom Demand
- B. EBF-1 Focus Cable
- C. MCA-6B Mounting Clamp
- D. EPA-S23 (A) Focus Position Demand Unit
- E. EPA-S23 (B) Focus Position Demand Unit
- F. EPA-S23 (C) Focus Position Demand Unit
- G. PF-19A-02A PF Action Switch

SS-21PF Servo Focus/Servo Zoom

For use with PF EPF lenses

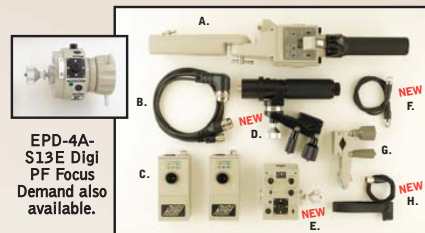
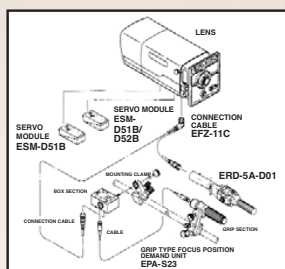

EPD-4A-S13E Digi PF Focus Demand also available.

- A. ERD-5A-D01 Digi Zoom Demand
- B. EFZ-11E Focus/Zoom Cable
- C. ESM-D51B Servo Module
- D. EPA-S23 (A) Focus Position Demand Unit
- E. EPA-S23 (B) Focus Position Demand Unit
- F. EPA-S23 (C) Focus Position Demand Unit
- G. MCA-6B Mounting Clamp
- H. PF-19A-02A PF Action Switch

For Sales Contact Information go to
www.Fujinon.com

For design help, accessories or pricing, please contact:
sales@avsupply or call: 1-858-565-1101