

# 1.3MPx and 3MPx Intelligent IP Dome Cameras

## IP Open Standards

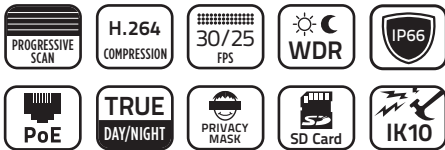

## OVERVIEW

TruVision IP Open Standards dome cameras bring state-of-the-art, high-definition pictures to the mass video surveillance market. With camera resolutions of 1.3 or 3 megapixel, these IP cameras represent a flexible video surveillance device to meet any need. Equipped with advanced technology and signal processing capability, they effectively capture video under challenging conditions.

TruVision cameras utilize H.264 compression technology with triple-streaming capability, making it easy to manage the camera's bandwidth usage. These cameras adhere to PSIA and ONVIF Profile S open communication standards, and also support a CGI command set for simple integration into any IP system. Video streams can be set for high or low bandwidth, and images can be streamed for live viewing or sent to a designated recording location.

These cameras go above and beyond standard motion detection with enhanced alarm capabilities, including cross lines, intrusion, de-focus and face detection features. Each is user-configurable to best suit the installation environment. A Region of Interest function ensures specific portions of an image are given priority during instances of high network traffic or network degradation.

Location-specific functions include a Hallway View Mode to provide a portrait view of a hallway or corridor, a De-Fog Mode to help resolve images through fog or rain and Electronic Image Stabilization for installations subject to physical vibration or shaking.



## STANDARD FEATURES

### Video

- 1.3MPx and 3MPx imagers
- H.264 compression technology with triple-streaming capability accommodates multiple settings
- Select models feature real-time video streaming up to 1080p resolution to capture every detail
- Designed to PSIA and ONVIF Profile S open standards

### Video Enhancement

- True Day/Night functionality and infrared illuminators to capture images in various lighting scenarios
- Up to 120dB of Wide Dynamic Range (WDR) performance for contrasting lighting environments
- ROI (Region of Interest), hallway view, mirror, de-fog, electronic image stabilization

### Advanced Alarm Intelligence

- Integrated motion detection and privacy masking
- Face detection, cross line, intrusion detection, de-focus detection, scene change detection
- Alarm inputs and outputs provide easy notification and control of events

### Edge Recording

- Edge recording supports up to 64GB micro SD/SDXC card for video playback

## Standard Features

### Environment and Installation

- Vandal-resistant housings and polycarbonate bubbles provide an extra level of protection
- Domes feature external analog BNC video out connection for easier installation and setup
- Included TruVision Device Manager program provides fast and easy access to newly added system devices
- UL approved

### Warranty

- 3-Year warranty

## Application

Delivering detailed images in a variety of environments that need it most, TruVision® IP cameras are specifically designed for applications that require high-quality IP images. These cameras provide ideal surveillance for environments such as retail, banking, airports or gaming where detailed image capture is critical for effectively monitoring people and transactions.

## Accessories – General Bracket

### TVD-SNB

Swan Neck Bracket

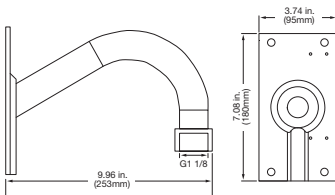

### TVD-SNB-BB

Back Box

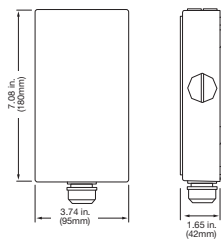

### TVD-PPB

Pendant Ceiling Bracket

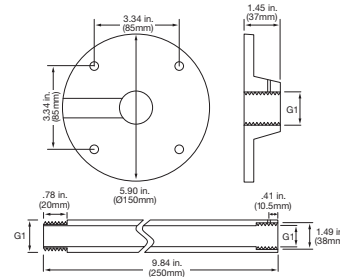

### TVD-M-PMA

Pole Mount Adaptor

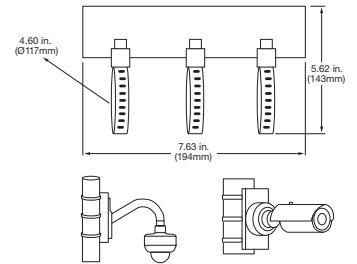

### TVD-M-CMA

Corner Mount Adaptor

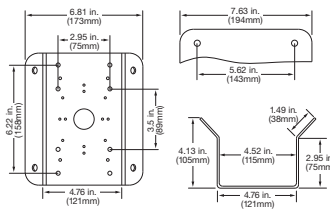

## Accessories – VF Mini Dome

### TVD-M2-WM

Indoor Dome Wall Mount

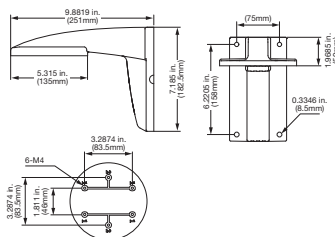

### TVD-M2-FM

Indoor Dome Flush Mount

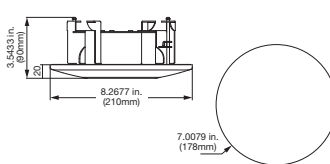

### TVD-CB3

3" Cup Base

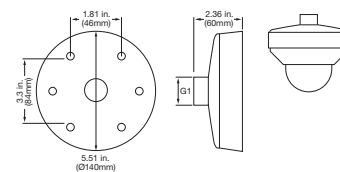



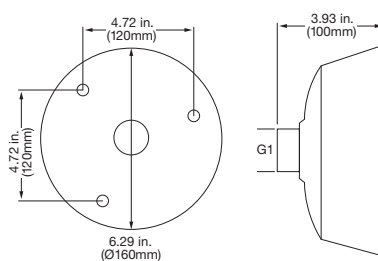

## Accessories – Motorized Lens Dome

### TVD-CB5A

Integrated 5" Cup Base



# Specifications

PART NO.	TVD-3201 TVD-1201	TVD-3202 TVD-1202	TVD-3203 TVD-1203	TVD-3204 TVD-1204	TVD-3205 TVD-1205
Description					
Sensor	1/3" Progressive Scan CMOS				
Day/Night	IR Cut Filter				
IP Compression	H.264 (Baseline profile / Main profile / High profile) / MPEG4 / MJPEG				
Maximum Resolution (@ fps)	1280 x 960 @ 25fps (50Hz) 1280 x 960 @ 30fps (60Hz)	2048 x 1536 @ 20fps (50Hz) 2048 x 1536 @ 20fps (60Hz)	1280 x 960 @ 25fps (50Hz) 1280 x 960 @ 30fps (60Hz)	2048 x 1536 @ 20fps (50Hz) 2048 x 1536 @ 20fps (60Hz)	
Maximum Real-Time Resolution (@ fps)	1280 x 960 @ 25fps (50Hz) 1280 x 960 @ 30fps (60Hz) 1280 x 720 @ 50fps (50Hz, WDR off) 1280 x 720 @ 60fps (60Hz, WDR off)	1920 x 1080 @ 25fps (50Hz) 1920 x 1080 @ 30fps (60Hz)	1280 x 960 @ 25fps (50Hz) 1280 x 960 @ 30fps (60Hz) 1280 x 720 @ 50fps (50Hz, WDR off) 1280 x 720 @ 60fps (60Hz, WDR off)	1920 x 1080 @ 25fps (50Hz) 1920 x 1080 @ 30fps (60Hz)	
Multiple Streaming	Triple streams				
Video Bit Rate	128 kbps to 16 Mbps, or user-defined				
WDR	120dB				
Sensitivity	Color 0.01 lux @ f1.2, AGC ON 0 lux IR ON	Color 0.1 lux @ f1.2, AGC ON 0 lux IR ON	Color 0.01 lux @ f1.2, AGC ON 0 lux IR ON	Color 0.1 lux @ f1.2, AGC ON 0 lux IR ON	
S/N Ratio	50 dB (AGC OFF)				
Auto Exposure (shutter)	50 Hz: 1/25s ~1/100,000s 60 Hz: 1/30s ~1/100,000s				
Composite Output (BNC)	1Vp-p composite output (75 Ω/BNC)		Internal BNC port for installation only		
Lens	2.8 ~12mm VF lens		2.8 ~12mm motorized lens		8 ~32mm motorized lens
Focus	Manual		one touch Remote Auto Focus		
IR Distance	98 ft. (30m)				164 ft. (50m)
Voltage Input	12VDC PoE (IEEE 802.3-af)		24VAC, PoE (IEEE 802.3-af)		
Current	0.67A		0.71A		
Power Consumption	Max. 8W	Max. 8.5W	Max. 12.5W (heater on)		
I/O Connection	1/1		2/2		
Others	RS-485				
Network Protocols	TCP/IP, UDP, HTTP, DHCP, DNS, DDNS, ezDDNS, DynDNS, RTP, RTSP, PPPoE, SMTP, NTP, SNMP, HTTPS, FTP, UPnP, NAT, MULTICAST, 802.1x, Qos, IPv4, IPv6				
PoE	IEEE 802.3-af				
Port	10/100Mbps, auto-negotiate, Ethernet port (RJ45)				
Media	Micro SD/SDXC				
Capacity	Up to 64GB				
Basic	Motion Detection, Tamper Proof, Privacy Mask				
Advanced	Face Detection, Cross Line, Intrusion Detection, De-focus Detection, Scene Change Detection				
Standard & Integration	ONVIF Profile S, PSIA, CGI				
Display mode	ROI (Region of Interest), Hallway View, Mirror, De-fog, Electronic Image Stabilization				
OSD	Text overlay and picture overlay				
Dimensions	5.51 x 3.94 in. (140 x 100 mm)		6.29 x 5.75 in. (159.8 x 146 mm)		
Weight	1.76 lbs. (800g)		4.63 lbs. (2100g)		
Storage Temperature	-4°F~158°F (-20°C~70°C)		-4°F~158°F (-20°C~70°C)		
Operating Temperature (cold start)	-22°F~140°F (-30°C~60°C)		-40°F~140°F (-40°C~60°C), with heater on		
Operating Temperature	-22°F~140°F (-30°C~60°C)		-58°F~140°F (-50°C~60°C), with heater on		
Environmental Rating	IP66				
Vandal Rating	IK10				
Compliance	FCC, CE, UL, C-Tick, REACH, RoHS, WEEE				

# 1.3MPx and 3MPx Intelligent IP Dome Cameras

North America  
T 855-286-8889

Latin America  
T 561-998-6114

IP Open Standards

## Dimensional Diagrams

Vandal Dome

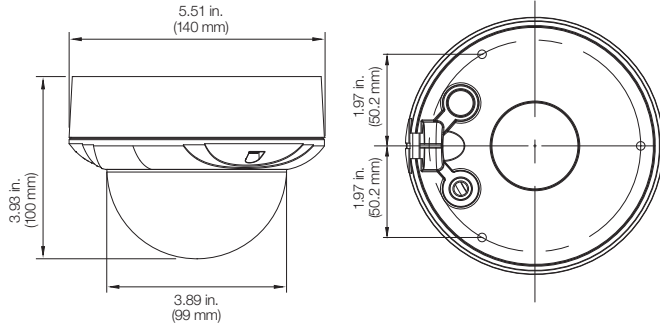

Motorized Vandal Dome

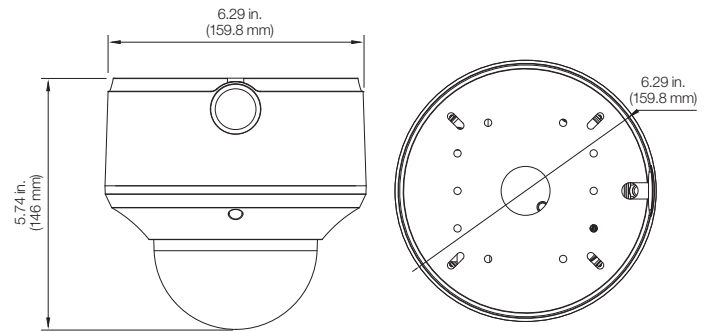

## Ordering Information

### NTSC

<b>TVD-3201</b>	TruVision® IP Vandal Dome Camera, 1.3MPx, 2.8~12mm VF Lens, WDR, True D/N, 30m IR, Alarm, SD/SHDC Slot, Intelligence, PoE (802.3-af) / 12VDC, IP66, IK10, NTSC
<b>TVD-3202</b>	TruVision IP Vandal Dome Camera, 3MPx, 2.8~12mm VF Lens, WDR, True D/N, 30m IR, Alarm, SD/SHDC Slot, Intelligence, PoE (802.3-af) / 12VDC, IP66, IK10, NTSC
<b>TVD-3203</b>	TruVision IP Motorized Lens Dome Camera, 1.3MPx, 2.8~12mm Motorized Lens, WDR, True D/N, 30m IR, Alarm, SD/SHDC Slot, Intelligence, PoE (802.3-af) / 24VAC, Heater, IP66, IK10, NTSC
<b>TVD-3204</b>	TruVision IP Motorized Lens Dome Camera, 3MPx, 2.8~12mm Motorized Lens, WDR, True D/N, 30m IR, Alarm, SD/SHDC Slot, Intelligence, PoE (802.3-af) / 24VAC, Heater, IP66, IK10, NTSC
<b>TVD-3205</b>	TruVision IP Motorized Lens Dome Camera, 3MPx, 8~32mm Motorized Lens, WDR, True D/N, 50m IR, Alarm, SD/SHDC Slot, Intelligence, PoE (802.3-af) / 24VAC, Heater, IP66, IK10, NTSC

### PAL

<b>TVD-1201</b>	TruVision IP Vandal Dome Camera, 1.3MPx, 2.8~12mm VF Lens, WDR, True D/N, 30m IR, Alarm, SD/SHDC Slot, Intelligence, PoE (802.3-af) / 12VDC, IP66, IK10, PAL
<b>TVD-1202</b>	TruVision IP Vandal Dome Camera, 3MPx, 2.8~12mm VF Lens, WDR, True D/N, 30m IR, Alarm, SD/SHDC Slot, Intelligence, PoE (802.3-af) / 12VDC, IP66, IK10, PAL
<b>TVD-1203</b>	TruVision IP Motorized Lens Dome Camera, 1.3MPx, 2.8~12mm Motorized Lens, WDR, True D/N, 30m IR, Alarm, SD/SHDC Slot, Intelligence, PoE (802.3-af) / 24VAC, Heater, IP66, IK10, PAL
<b>TVD-1204</b>	TruVision IP Motorized Lens Dome Camera, 3MPx, 2.8~12mm Motorized Lens, WDR, True D/N, 30m IR, Alarm, SD/SHDC Slot, Intelligence, PoE (802.3-af) / 24VAC, Heater, IP66, IK10, PAL
<b>TVD-1205</b>	TruVision IP Motorized Lens Dome Camera, 3MPx, 8~32mm Motorized Lens, WDR, True D/N, 50m IR, Alarm, SD/SHDC Slot, Intelligence, PoE (802.3-af) / 24VAC, Heater, IP66, IK10, PAL

## Part Number Schema

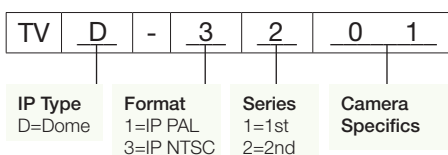

interlogix.com

Specifications subject to change without notice.

© 2015 United Technologies Corporation.

All rights reserved.

Interlogix is part of UTC Building & Industrial Systems,  
a unit of United Technologies Corporation.

412-3881 2015/01 (80110)