



INNOVATIVE
HIGH DEFINITION SURVEILLANCE



OMNI Resolution 960 Everyday

 **KPC-VNNS102NUV**

Outdoor, True Day/Night 750 TVL,
Rugged, 3-Axis, 2.8-12mm, 131' IR
Range, IP66, Dual Voltage, -40°

KPC-VNNS102NUV: 2.8-12mm



INNOVATIVE
HIGH DEFINITION SURVEILLANCE



OMNI
Resolution 960
Everyday

KPC-VNNS102NUV

Outdoor, True Day/Night 750 TVL,
Rugged, 3-Axis, 2.8-12mm, 131' IR
Range, IP66, Dual Voltage, -40°

Features

- Superlative resolution of over 750 horizontal TV lines for amazing image quality
- 960H CCD sensor with high IR sensitivity
- True Day/Night zero light operating range of 131 feet or more from 30 IR LEDs (depending on scene reflectivity) with Smart automatic exposure level adjust to achieve the desired IR brightness in a user defined area
- Simple and easy to use OSD setup menu
 - Digital Wide Dynamic Range for proper contrast in challenging bright or unbalanced scene lighting conditions
 - Anti Color Roll for proper white balance independent of fluorescent or other types of illumination
 - Programmable Back Light Compensation (BLC) and Highlight Compensation (HLC)
 - Adjustable 2D-Noise Reduction to increase low light picture clarity and conserve DVR HDD disk space
 - Privacy masking for 8 configurable zones
 - Lens shading compensation for even exposure out to the lens periphery
- 2.8~12mm 2 Megapixel Aspheric Varifocal DC iris lens to capture the desired field of view
- Dual voltage (12VDC/24VAC) with Anti Color Roll
- IP66 weather resistant
- Extreme Operating temperature down to -40 degrees
- Service Video output for convenient installation, and ease of service
- 3-Axis gimbal for convenient wall or ceiling mounting
- Flush or Surface mountable (surface mounting/splice box fits standard 3/4" conduit and electrical boxes)
- KA-WM100 Optional wall mount bracket with 3/4" conduit fitting.

Dimensions: Inches (mm)

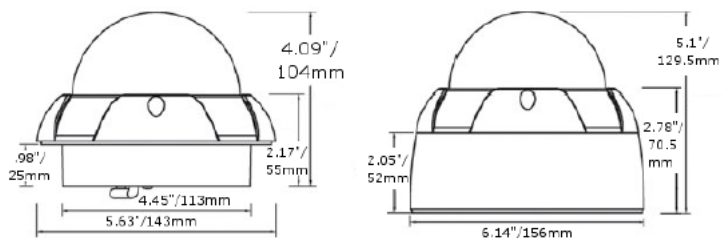

Accessories



KA-WM100
Wall Mounting Bracket
with 1/2" conduit fittings
top and bottom

AUDIO VIDEO SUPPLY 3 Axis Rugged Housing IP66 Water Resistant -40°F

DC12 Dual Voltage AC24V Surface or Flush Mount OSD BLC HLC Low Light Performance Anti-CR Service Video

Imaging Device	1/3" 960H High Sensitivity CCD
Video Format	NTSC
Picture Elements	NTSC: 1020(H)x508(V)
Effective Picture Elements	NTSC: 976(H) x 494(V)
Horizontal Resolution	More than 750 TVL
Sensitivity	0 lux IR on; .01 lux native from sensor
IR LED	30 LEDs, 850nm
IR Range*	131' (* As with all IR cameras, IR range will vary based on scene IR reflectivity and illumination)
Smart IR Exposure Adjust	Off/On; adjustable for gain, size and location of sensing area
S/N Ratio	Over 50dB (AGC off)
Video Output	BNC 1.0V p-p 75Ω; video test point inside dome, cable supplied
Gamma Correction	0.45
Lens Type	2 Megapixel Aspheric Varifocal DC Iris 2.8~12mm F=1.6
Lens Positioning	3-axis flexible positioning for wall or ceiling mounting
Back Light Compensation	OFF/BLC/HLC Selectable
Auto Gain Control	Off/Low/Middle/High
Electronic Shutter	Auto; or 1/60, FLK, 1/250, 1/500, 1/1000, 1/2000, 1/4000, 1/5000, 1/10000, 1/100000
White Balance	ATW/AWB/AWC->SET/Anti-Color Roll/Manual
Sync. Mode	Internal (plus Anti-Color Roll White Balance option above)
Day & Night	Auto True D/N with motorized ICR; controlled by photo sensor. Choose Auto, color or B/W
OSD Menu	Multiple functions using 3-axis joystick
OSD Languages	English, Spanish, Portuguese, German, Russian, Japanese, Chinese, French
2D-DNR	On/Off (Level Adjustable)
Digital Wide Dynamic Range	On/Off (Level Adjustable)
Mirror	Off/On
Motion Detection	Off/On for 4 selectable zones (On screen indication)
Privacy Mask	Off/On for 8 selectable zones
Lens Shading Correction	Off/On with adjustable level and center
Other OSD Functions	Camera Title with position, Font Color, Image Contrast/Sharpness, CRT/LCD display optimization, Negative Image, DPC (Dead Pixel Compensation)
Power Source	12VDC/24VAC
Power Consumption	12VDC:420mA max. / 24VAC:4.8W max.
Operating Temperature	-40°F~140°F ; -40°C~60°C
Environmental	IP66 weather resistant
Mechanical	Vandal proof dome; back box accepts 3/4" conduit fittings and hole pattern matches various standard electrical boxes; remove back box for flush mounting
Dimensions	Surface: 6.14"/156mm dia. x 5.1"/129.5mm high Flush: 5.63"/143mm dia. X 3.11"/79mm visible & .98"/25mm behind surface
Weight	1.2 pounds flush mounted; 2.8 pounds with surface mount conduit compatible back box
Certifications	CE , FCC, RoHS
Environmental	IP66 weather resistant

KPC-VNNS102NUV: 2.8-12mm