

| REV | CHANGE RECORD AND DATE | CH |
|-----|------------------------|----|
| A | RELEASE 09/04/03 | |

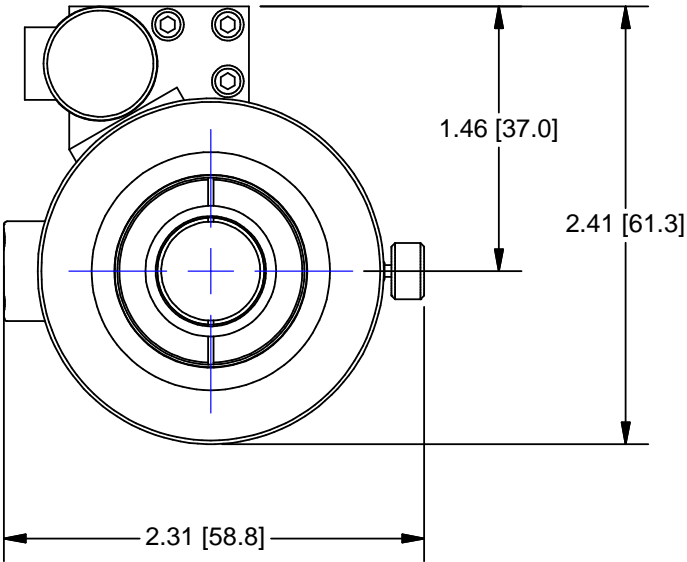

2-PHASE MOTOR PINOUT

PIN 3 = +5Vdc
 PIN13 = COMMON
 PIN 8 = FAR LIMIT
 PIN 12 = NEAR LIMIT
 PIN 1 = MOTOR A+
 PIN 7 = MOTOR A-
 PIN 6 = MOTOR B+
 PIN 11 = MOTOR B-

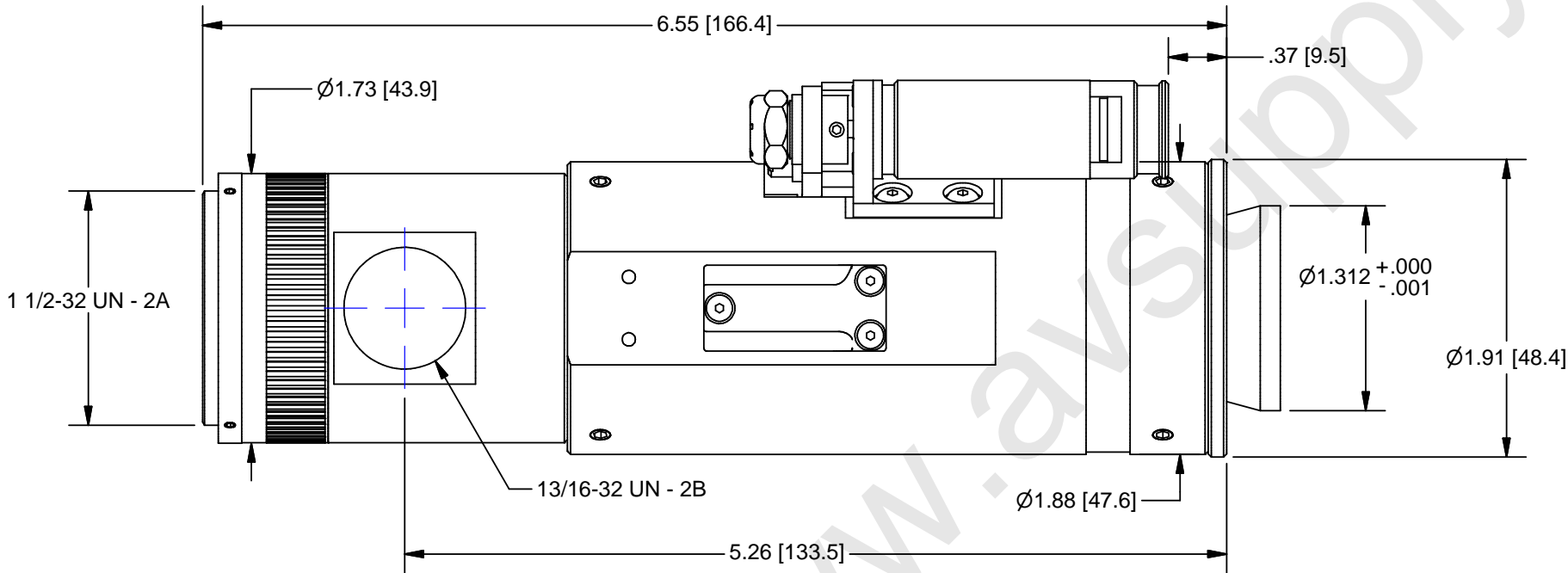
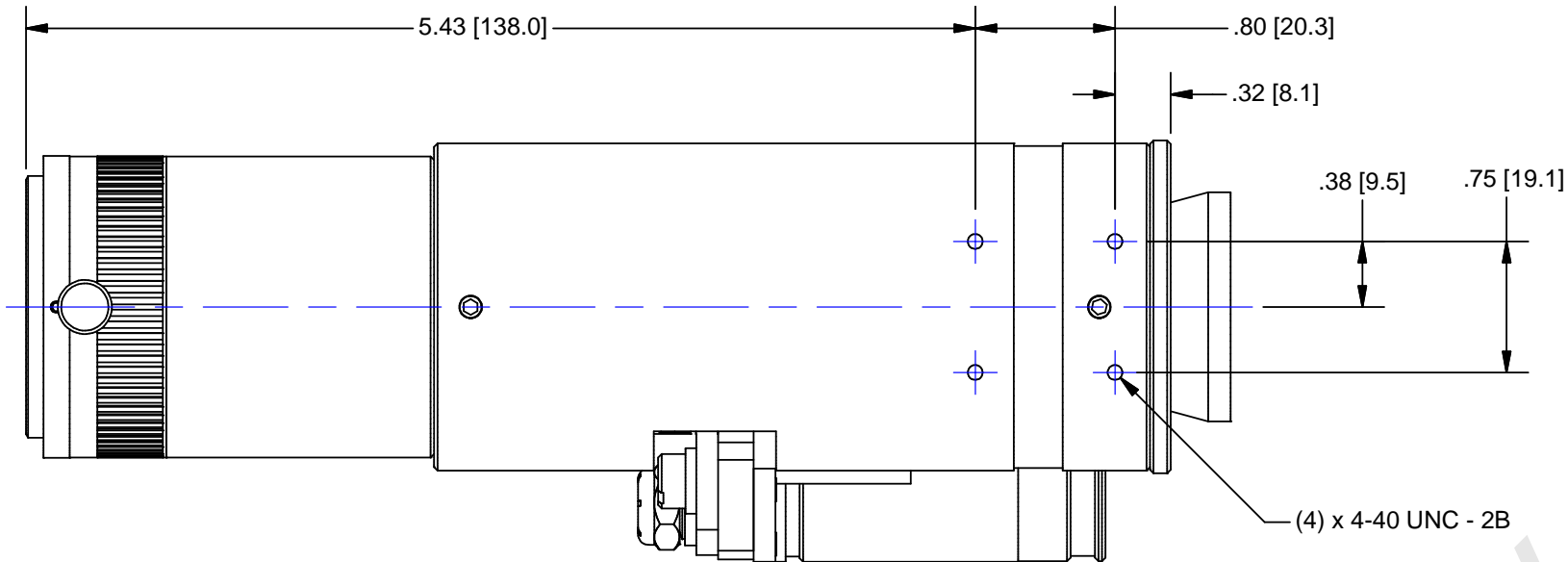
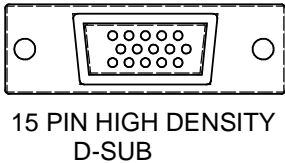

| | | | | | |
|--|--|---|---|--|---|
| USED ON: MATERIAL: | | UNLESS OTHERWISE SPECIFIED DIMENSIONS ARE IN INCHES AND INCLUDE CHEMICALLY APPLIED OR PLATED FINISHES | P/N SUFFIX DEFINITION -1 CONVERSION COATING -2 PAINTING -3 MARKING -R REWORK | THE CONTENTS OF THIS DOCUMENT ARE PROPRIETARY TO NAVITAR, ITS USE IS AUTHORIZED ONLY FOR RESPONDING TO REQUEST FOR QUOTATION OR PERFORMANCE OF WORK FOR NAVITAR | ROCHESTER, NEW YORK |
| FINISH: | | TOLERANCES: DEC. .XXX ± .005 DEC. .XX ± .010 FRACT. ± 1/64 ANGLES ± 30' CONCENTRICITY .003 TIR BREAK ALL SHARP EDGES .005 MIN. .010 MAX MAX. SURF. ROUGHNESS 32 | SCALE: 1:1 DR.: R. PODLENA CH.: P. BONAFEDE APP.: DATE DR.: 9/16/2003 DO NOT SCALE DRAWING | | |
| CHAMFER ALL THREADS 30° TO ROOT DIAM. | | | | 0.0 inch 1.0 0.0 mm 25.0 | MOTORIZED (STEP) 12X w/2 POS. LS 1-800-284-2288 sales@avsupply.com www.avsupply.com |

OUTLINE