

# MTV2X0916D



Type	AI VARI		Mount	CS		
Focal Length	9.0~22mm		Back Focus	9.02~18.20mm		
Fno.	F1.6		Mechanical Bf	8.3mm		
Designed Image Format	1/3"(4.8x3.6mm)		Exit Pupil	—		
Operation Range	Iris	F1.6—F360	Filter Size	—		
	Focus	0.3m ~ ∞	Aperture	Front	∅10.3mm	
	Zoom	9.0~22mm		Rear	∅6.5mm	
Control	Iris	DC Galvanometer	Dimension	33,6x44.0x45.0mm		
	Focus	Manual		Weight	55g	
	Zoom	Manual				
Object Size at MOD	Wide	—				
	Tele	—				
Field of View	D	38.4°~16.2°	1/4"	28.46°~12.1°		
	H	30.3°~12.9°		22.5°~9.7°		
	V	22.5°~9.7°		16.8°~7.3°		
Control	Iris		Focus		Zoom	
Driving Coil/Supply Volt.	190Ω		—		—	
Damping Coil/Current	465Ω		—		—	
Response Time	—		—		—	
Potentiometer	—		—		—	
Light Measuring Method	—					
Input Signal	—					
Iris Accuracy	—					
Sensitivity Adjustment	—					
Operating Temperature	-5°C ~ +50°C					

1/3"  
CS  
CSD

## DIMENSIONS

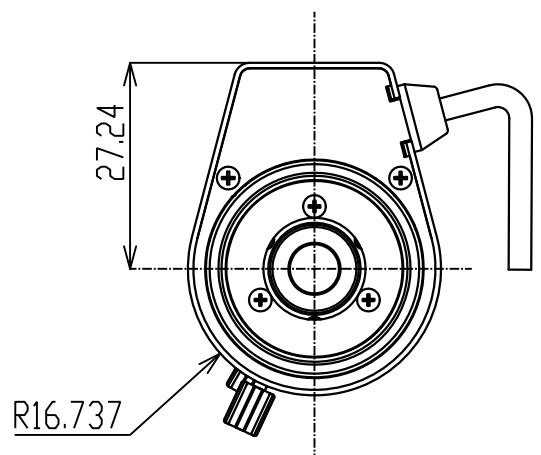
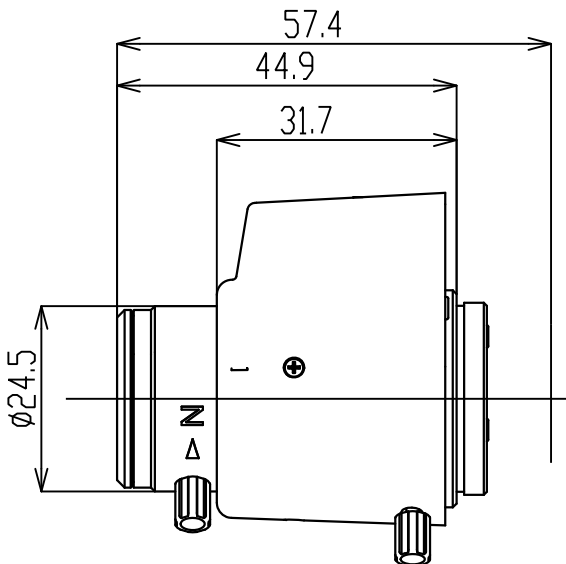

## Wiring Diagram

1) 4 Pin Standard Connector for Auto Iris

Pin No.1	Damping (-)
2	Damping (+)
3	Driving (+)
4	Driving (-)

