

JHF12M-MP2

【SPECIFICATIONS】 Megapixel-Lens

Image Size: 2/3

Focal Length: 12mm
Maximum Relative Aperture: 1:1.8
Iris: F1.8~Close
Angle of View: 40.3×30.8°
Image Size: 8.8×6.6mm (φ11mm)
Minimum Object Distance: 0.2m (From Front Vertex)
Optical Distortion: Max -0.98% (at near)
-0.37% (at far)
TV Distortion: -0.22% (at near)
0.10% (at far)

Optical Back Focal Distance: 14.00mm(In Air)
Frang Back: 17.526mm
Operation: Focus: Manual
Iris: Manual
Operating Temperature: -10~+50°C
Mount: C-Mount
Filter Size: 35.5mm P0.5
Size: φ39.5×59mm
Weight: Approx.145g

【COMPOSITION】

Lens 1
Lens Cap 1
Dust Cap 1

【DIMENSIONS】

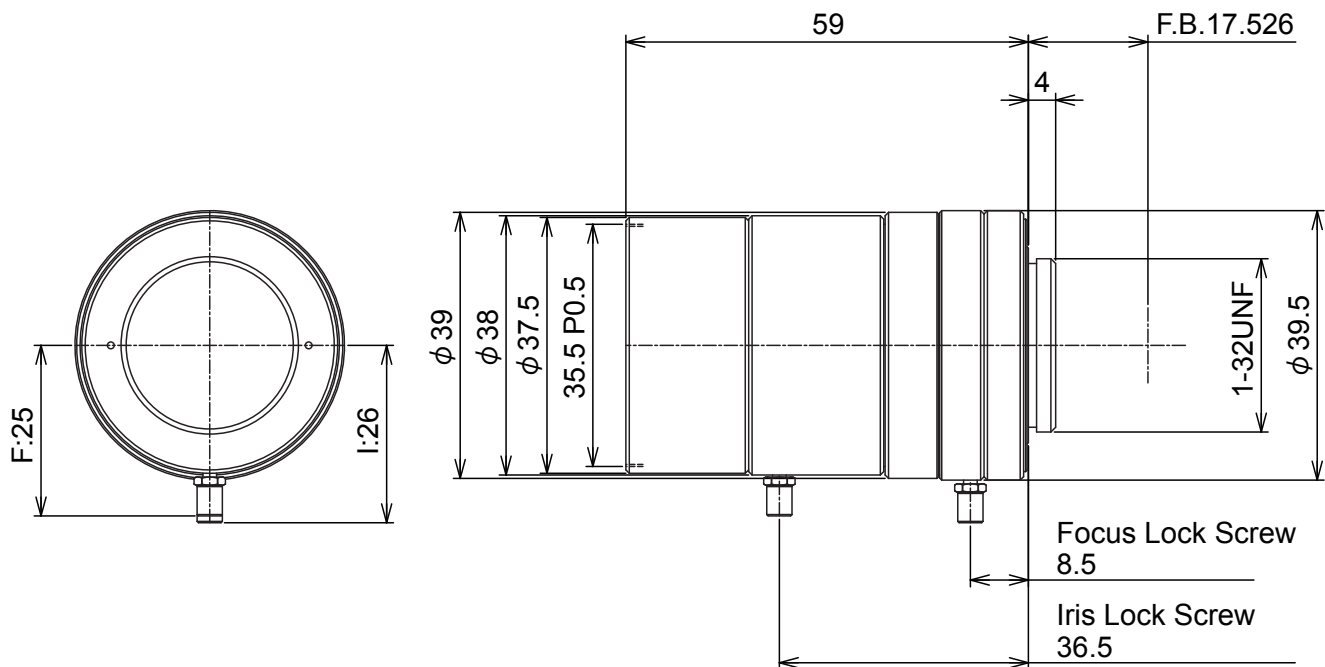

Unit:mm