



Fusion Camera Housing 360°

Fusion Camera Housing with Panomorph Lens Option

The Fusion Camera Housing (FCH) now enables cameras equipped with CS mount Panomorph lenses, to be used in conjunction with wall or pole mount applications, both indoors and outdoors. The FCH Series of environmental camera enclosures is designed to fit a multitude of rugged outdoor surveillance applications. The housing is constructed of resilient polycarbonate and has a wall / pole mount comprised of cast aluminum with a durable powder coat finish to ensure protection of your camera even in harsh conditions. Additionally, the heavy-duty wall / pole mount keeps cables protected and out of sight with its feed-thru capability. This feature coupled with the side-hinged lid and tool-free camera tray ensures easy installation and servicing of your camera.

Outdoor models are equipped with an advanced climate control system that incorporates distributed air-flow and provides warm, dry air where you need it most...on the viewing window. This "built-in" de-fogging system delivers clear viewing, even in tough conditions. Also available is a Power over Ethernet (PoE) plus model with patent pending Moog Dynamic Power Allocation (DPA) technology. PoE reduces installation time by simplifying wiring needs, while DPA prioritizes power to the camera over other less critical electronics. Perhaps most importantly, the Fusion Line is compatible with most leading IP and analog camera manufacturers making it the professional's choice for environmental camera housings.

Available Features

- Meets NEMA Type 4X and IP66 standards
- Adjustable sunshield ("V" models)
- Hinged wall mount allows for easy installation
- Compatible with ImmerVision *Enables*® panomorph lenses and most qualified box cameras
- Standard wall / pole mount
- PoE or 12/24v input model
 - Supports PoE Plus IEEE802.3at compliant cameras
 - True PoE power to the camera (no splitter needed)
 - Automatically adjusts for power loss in long cable
 - DPA ensures maximum power to the camera



FCH360

Models:

FCH360CW

Environmental indoor / outdoor housing accommodates an ImmerVision *Enables* panomorph lens and qualified box camera with feed-thru wall / pole mount

FCH360C2WY

Environmental indoor / outdoor housing accommodates an ImmerVision *Enables* panomorph lens and qualified box camera with feed-thru wall / pole mount, with adjustable sunshield

FCH360C8WY

Environmental indoor / outdoor housing accommodates an ImmerVision *Enables* panomorph lens and qualified box camera with feed-thru wall / pole mount, DPA, PoE input, 30 watt midspan included, heater and blower, supports IEEE802.3at PoE cameras, adjustable sunshield

Easy Installation Features:

- 1 Housing hinges away from mount to simplify wiring process
- 2 Feed through wall / pole mount protects wiring and provides a clean appearance
- 3 Provision for conduit access through mount arm
- 4 Side housing hinge allows easy camera access

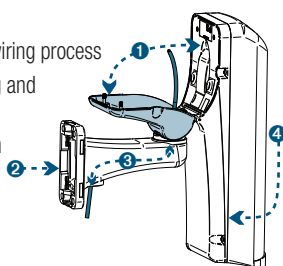

ImmerVision *Enables* 360° Panomorph Lenses



ImmerVision's patented optic technology combines 360° panomorph lenses and immersive software algorithms to enable 360° functionalities for a variety of indoor and outdoor applications. Moog offers a suite of enclosures and mounting accessories to accommodate the growing need for 360° surveillance in any environment.

Lens Sold Separately

Fixed Camera Housing Accessories:



CM900

Aluminum ceiling mount bracket



MA-900

Aluminum mast arm mounting bracket, uses 1.5" NPS thread for mounting in traffic applications

General Specifications		
Camera Included:		No
Max camera length (camera/lens):		11" (280mm)
Mounting Style:		Wall or Pole
Size (l*w*h):		17.9" x 5.7" x 10.5" (455 x 145 x 267mm)
Weight:		4.5 lbs
Electrical Specifications		
Input Voltage:		PoE (IEEE802.3at) or 12/24v input model
Power Consumption	24Vac:	27 watts: Heater & Blower
	12Vdc:	10 watts: Heater & Blower
	PoE:	25 watts: Camera, Blower & Heater
Power Output	24/12v:	Same as input, minus power for Heater & Blower
	PoE:	IEEE802.3af
Shipping Specifications		
Model	Shipping Weight	Box Dimensions
FCH360 Series:	6.5 lbs	8.25" x 11.75" x 19.5" (209 x 298 x 495mm)
Regulatory and Certifications		



CE

NEMA

NEMA Rating



WEEE



RoHS



CUL



UL



REACH

Environmental Specifications	
Blower:	Yes (Continuous)
Effective Projected Area (EPA):	90.8 in2
Heater activates at:	60°F (15.5°C)
Heater deactivates at:	80°F (27°C)
IP rating (Weather rating):	IP66 / NEMA 4X
Maximum Windload:	150mph (240kph)
Operating Temperature:	-50°F to 122°F (-45°C to 50°C)
Mechanical Specifications	
Construction Body and Top:	Polycarbonate
Mounting Bracket Construction:	Cast aluminum
Mounting Pattern (W x H):	2" x 4.25" (51 x 108mm)
Window Construction:	Acrylic
Architectural Drawings	

Dimensions are in inches (mm)

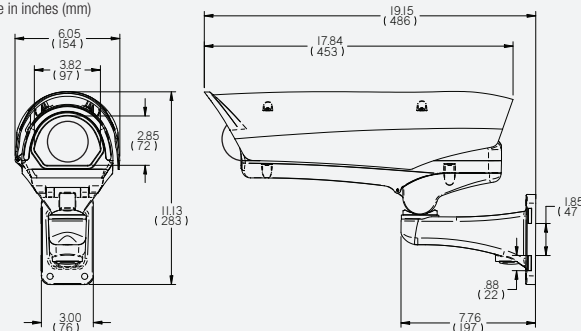

MOOG

Sensor and Surveillance Systems

3650 Woodhead Drive Northbrook, IL, USA 60062

+1.847.498.0700 Fax: +1.847.498.1258 www.moogS3.com