



## RC200C

### Rotating Ceiling Housing

This low profile camera housing is designed for use in suspended ceiling applications, replacing a standard 2' x 2' ceiling tile. Its unique design allows the unit to be manually rotated 360°, and the compact size is ideal for use with a fixed, 11" camera and lens combination. The light weight of the RC200C means no special supports are needed.

#### Available Features

- Housing is manufactured from high-impact, off-white ABS plastic
- OD1 optional metal back box available for plenum applications to comply with standard building codes
- The unit is fully adjustable for 360° positioning
- Lightweight plastic housing requires no special ceiling support attachments
- Viewing window sonically welded to a snap-in mount



# RC200C

## 2' x 2' Rotating Ceiling Housing: IP Fixed Network

### RC200C

The RC200C is constructed from a high-impact, off white plastic. The IP network ready rotating fixed ceiling camera housing is meant to replace a 2' x 2' ceiling tile. No special ceiling support attachments needed. Fully adjustable for 360° positioning



Camera as it appears in the RC200C housing

## Compatible Cameras:

To view the latest compatible cameras please visit:

[www.moogs3.com/technical-support/tools-software/camera-compatibility-tool/](http://www.moogs3.com/technical-support/tools-software/camera-compatibility-tool/)

### Fixed:

(ACTi) KCM-5111, TCM-521

(American Dynamics) ADC733 series, Discover 600Series, ADCIPEB series, Illustra 400 Series

(Arecont) AV10005, AV10115, AV1115, AV1300, AV1305, AV1310, AV2100, AV2105, AV2110, AV2115, AV2805, AV3100, AV3105, AV3110, AV3115, AV5100, AV5105, AV5110, AV5115

(Avigilon) H3-B2, HD-DN, HD-H264-B1, HD-PRO

(Axis) M11 series, Q1755

(Bosch) Dinion LTC Series, NBC-225P, NBC-255P, NBC-256P

(Cisco) 2600, 4300E, 4500E

(Interlogix [UTC]) TVC-M\*, TVC-N\*

(iQinVision) IQeye 3 Series, IQeye 700 Series

(JVC) VN-H137U, VN-H37U, VN-H57U, VN-T16U

(Panasonic) WV-NP244, WV-SP102, WV-SP105, WV-SP302, WV-SP305, WV-SP306, WV-SP508, WV-SP509

(Pelco) C20, Sarix IX series

(Samsung) SCB-1000, SCB-2000, SCB-2001, SCB-3000, SCB-3001, SCB-4000, SCB-6000, SCZ-2370, SCZ-3250, SCZ-3370, SCZ-3430, SNB-1001, SNB-5200

(Siquira) BC62, BC64, BC820

(Sony) SSC-FB530, SSC-FB560, SSC-G103, SSC-G113A, SSC-G203, SSC-G213A

(Toshiba) IK-6210A, IK-6410A, IK-6420A, IK-64DNA, IK-6550A, IK-65WDA

(UTC Security) UltraView, UltraView IP

(Verint) S5000, S5120

## Mechanical Specifications

Size (h*w):		2' x 2' (51 x 51mm)
Construction	HOUSING:	94HB ABS plastic
	BRACKETS:	Stainless steel
	SNAP-IN MOUNT:	4" x 2.9" (102 x 74mm)
Dust Cover (Optional):		Metal
Viewing Window:		Clear acrylic

The housing shall be capable of 360° manual rotation without the use of secondary brackets or plates. The view panning adjustment shall be unlimited, with locking tabs provided to secure desired viewing angle. An adjustable stainless steel camera bracket shall be included.

## Environmental Specifications

Operating Temperature:	-20°F to 120°F (-29°C to 49°C)
------------------------	--------------------------------

## Dimensions / Architectural Drawings

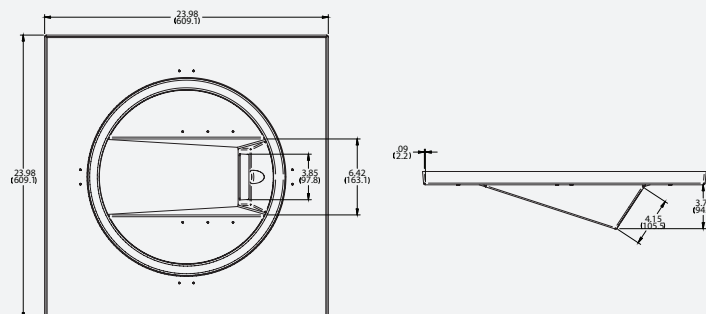

Dimensions are in inches (mm)

# MOOG

Sensor and Surveillance Systems

3650 Woodhead Drive Northbrook, IL, USA 60062

+1.847.498.0700 Fax: +1.847.498.1258 [www.moogS3.com](http://www.moogS3.com)