

# EXPTC010G

## EXPLOSION-PROOF P&T FOR THERMAL CAMERAS

### MAIN FEATURES

Solid anticorodal aluminium construction  
 Epoxy polyester powder painting, RAL7032  
 Germanium window  
 IP66  
 Housing supplied with heater. Sunshield as option

### DESCRIPTION

The Pan & Tilt unit EXPTC010G is made with strong Anticorodal aluminium die-cast alloy of AlSi 7Mg EN - AB 42000 group. EXPTC010G is equipped with a germanium viewing window designed for Thermal Imaging Camera installations. The germanium window composition with remarkable properties covers transmission from 7.5 to 14µm IR range with the best optical quality. All external components are stove enamelled. Construction according to the 94/9/CE ATEX and GOST-R standards.

The system includes a housing with the same characteristics of the EXHC000G and a Pan & Tilt, designed for movement both in horizontal and vertical planes. The peculiar characteristic of the device is the absence of external wiring in rotation, either for the control of the Pan & Tilt or for the camera and lens. This solution makes the installation and the maintenance of the Pan & Tilt easy. One multiconductor cable comes out from the base of the Pan & Tilt through a cable-gland. The EXPTC010G is supplied with preset, autopan and housing heater and optional sunshield.



EXPTC010G + EXPTS



**TECHNICAL DATA****GENERAL**

Non-corrosive die-cast aluminium (anticorrosive)  
Bicomponent polyurethane enamel with orange peel effect, RAL7032

**MECHANICAL**

- 1x Ex d 3/4" NPT IP66 ATEX cable gland for armoured cable at the base of the P&T
- One multiconductors armoured cable normally supplied 7.5m (24ft) length, diameter 20.8mm (0.8in): 25 poles 0.5mm, 4 poles 1mm, 2 RG175 of 750hm

External dimensions: 571.4x427.5x560mm (22.5x16.8x22in)

Internal dimensions: Ø 180x460mm (7,1x18.1in)

Internal usable area: 100x100x280mm (3.9x3.9x11in)

Unit weight: 56.5kg (124.6lb)

Germanium window

- Dimensions (Ø): 155mm (external), 114mm (4.5in) (internal)
- Thick: 12mm
- External scratch-resistant treatment: Hard Carbon Coating (DLC)
- Internal antireflection treatment
- Spectral range: 7.5µm ÷ 14µm

**ELECTRICAL**

Power supply IN 24Vac, 50/60Hz

Horizontal and vertical motor consumption: 50W max

Standard vertical and horizontal preset potentiometers

Heater Ton 10°C±4°C (50°F±7°F) Toff 25°C±3°C (77°F±5°F)

- IN 24Vac, consumption 20W max

Devices to install inside the housing

- Camera equipped with lens with max total power of 20W
- Power supply max 24Vac (only for analog camera)
- Usable volume for camera/lens: 2800cm<sup>3</sup>
- Minimum distance between the walls of the housing and the camera/lens: 12mm

**ENVIRONMENT**

Indoor/Outdoor

Operating temperature with heating: -20°C / +50°C (-4°F / +122°F)

Always refer to the temperature in the marking.

**CERTIFICATIONS**

ATEX (EN 60079-0: 2009, EN 60079-1: 2007, EN 60079-31: 2009)

- II 2G Ex d IIC T6 Gb
- II 2D Ex t IIIC T85 °C Db IP66

CE 0044: notify number from competent body

GOST-R

- 1 Ex d IIC T6 Gb
- Ex tb IIIC T85 °C Db IP66

**ACCESSORIES**

EXPTS000 Sunshield 650mm for EXPT series

**RELATED PRODUCTS**

EXDTRX3 Data telemetry receiver 17 functions, 230Vac

EXDTRX324 Data telemetry receiver 17 functions, 24Vac

**BRACKETS AND ADAPTORS**

EXPTWB000 Bracket RAL7032 for EXPT series

**PACKAGE**

Model Number	Weight	Dimensions (WxHxL)	Master carton
EXPTC010G	61.2kg (135lb)		76x41x67cm
(30x16x26.4in)	-		

**TECHNICAL DRAWINGS**

Sizes in millimeters.

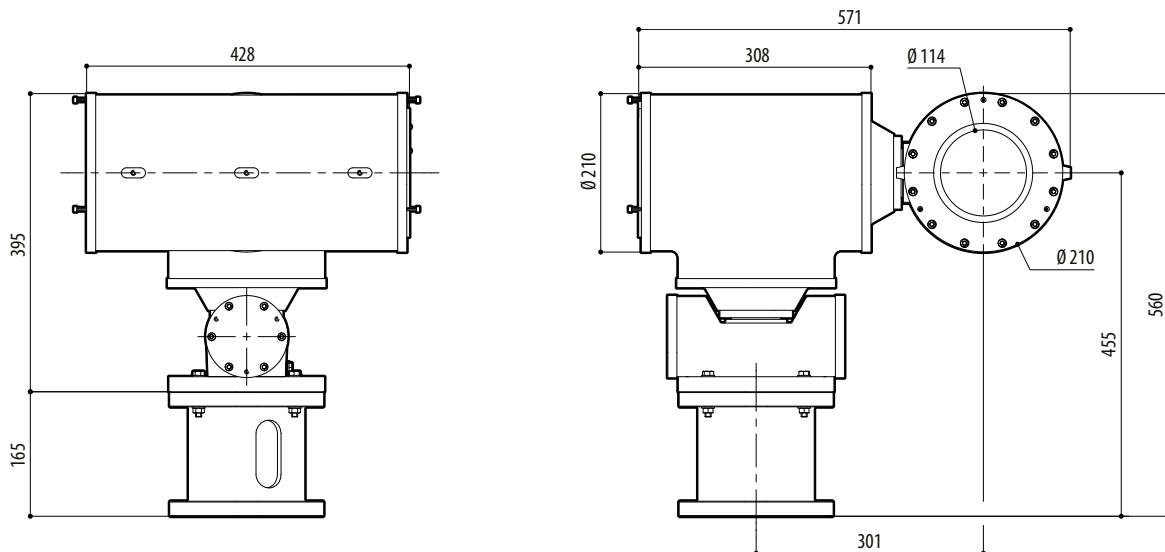

EXPTC010G